

ASSEMBLY INSTRUCTIONS PARTS LIST

CM24 CM36 CM48

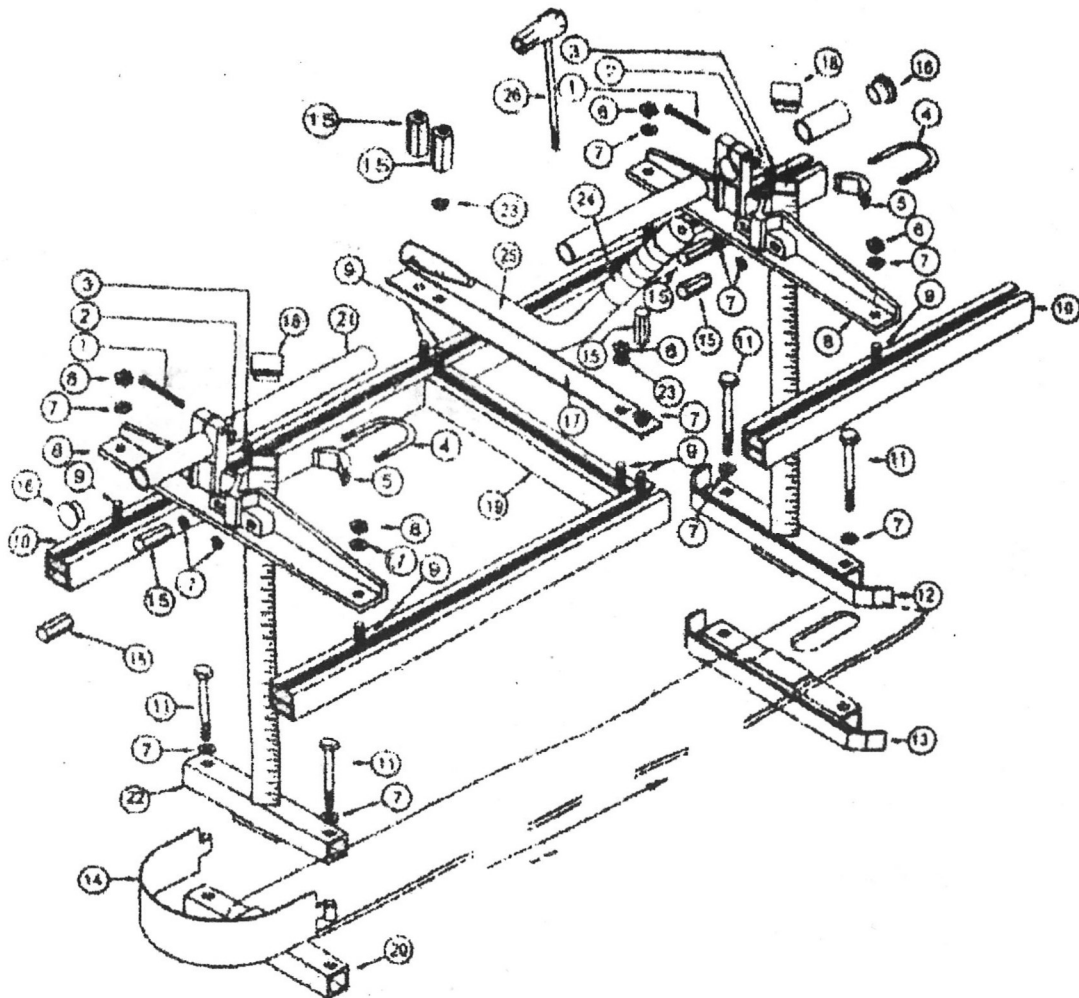

ITEM NO	PART NO	QTY	DESCRIPTION
1.	809	2	PAN HD.SCREW 10-32
2.	323	2	NO LONGER USED
3.	935	2	HEXHD.LOCK NUT 10-32
4.	1794	2	U-CLAMP.5/16-18
5.	804	2	POST CLAMP
6.	684	6	HEXNUT.5/16-18
7.	871	15	FLAT WASHER.5/16
8.	782	2	END BRACKET
9.	805	8	CRG BOLT 5/16-18X3/4
10.	781-2	2	THICKNESS RAIL G-776-24
	781-3	2	THICKNESS RAIL G-776-30
	781-4	2	THICKNESS RAIL G-776-36
	781-5	2	THICKNESS RAIL G-776-48
	781-6	2	THICKNESS RAIL G-776-58
11.	779	4	HEX BOLT5/16-18X3-1/2
12.	791	1	ADJ.POST/THRUST EMD
13.	790	1	CLMP BRKT./THRUST END

ITEM NO	PART NO	QTY	DESCRIPTION
14.	795	1	NOSE GUARD
15.	702	7	COUPLING NUT5/16-16
16.	785	2	END CAP/HANDLE
17.	784	1	TIE BAR
18.	778	2	END CAP/RISER POST
19.	799	1	ON-OFF GUIDE BAR
20.	788	1	CLMP.BRKT./NOSE END
21.	793-1	1	HANDLE G-776-24
	793-2	1	HANDLE G-776-30
	793-3	1	HANDLE G-776-36
	793-4	1	HANDLE G-776-48
	793-5	1	HANDLE G-776-56
22.	792	1	ADJ.POST/NOSEEND
23.	685	2	LOCK WASHER
24.	874	1	GRIP
25.	596	1	HANDLE
26.	703	1	WRENCH

S/L ILLUSTRATED PARTS 2003/776-1202

1

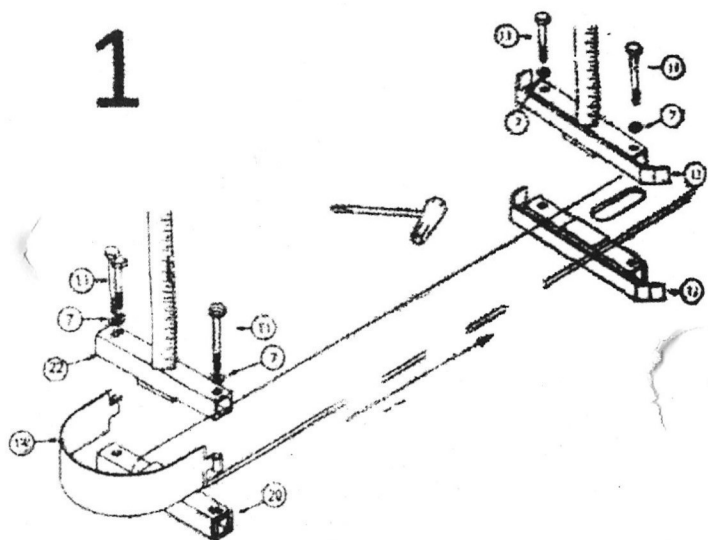

3

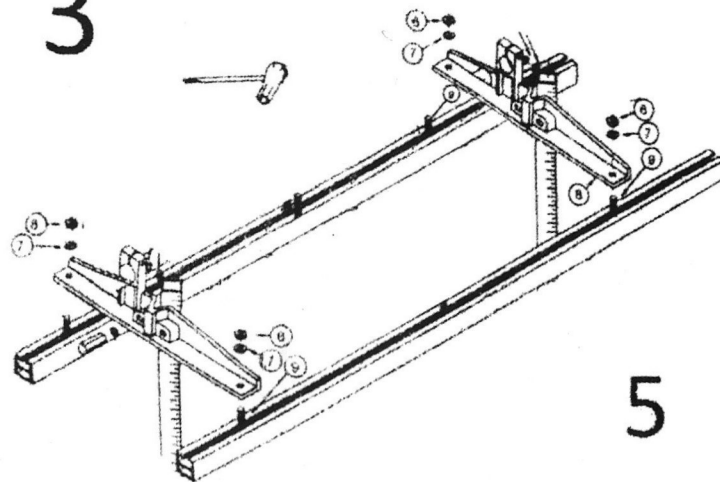

2

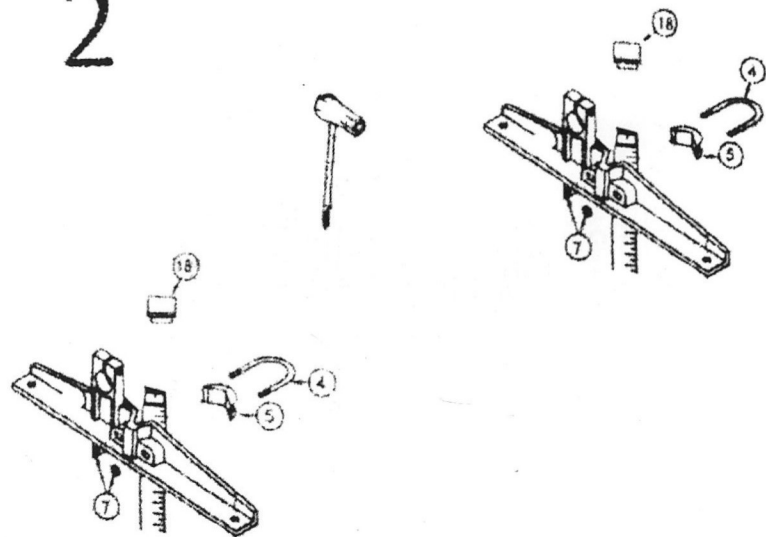

5

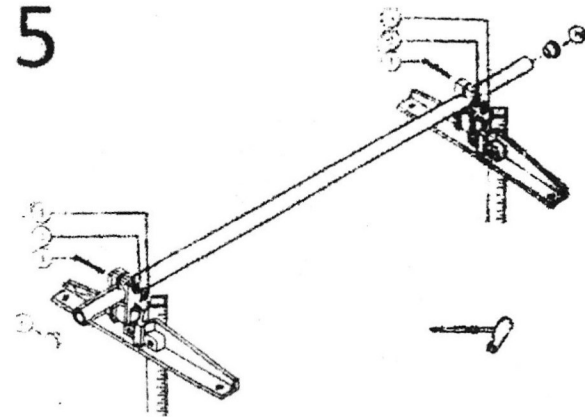

4

